

HIGGINS & Mc CORMICK'S
 ADDITION
 TO
 MISSOULA
 SCALE 200' = 1"

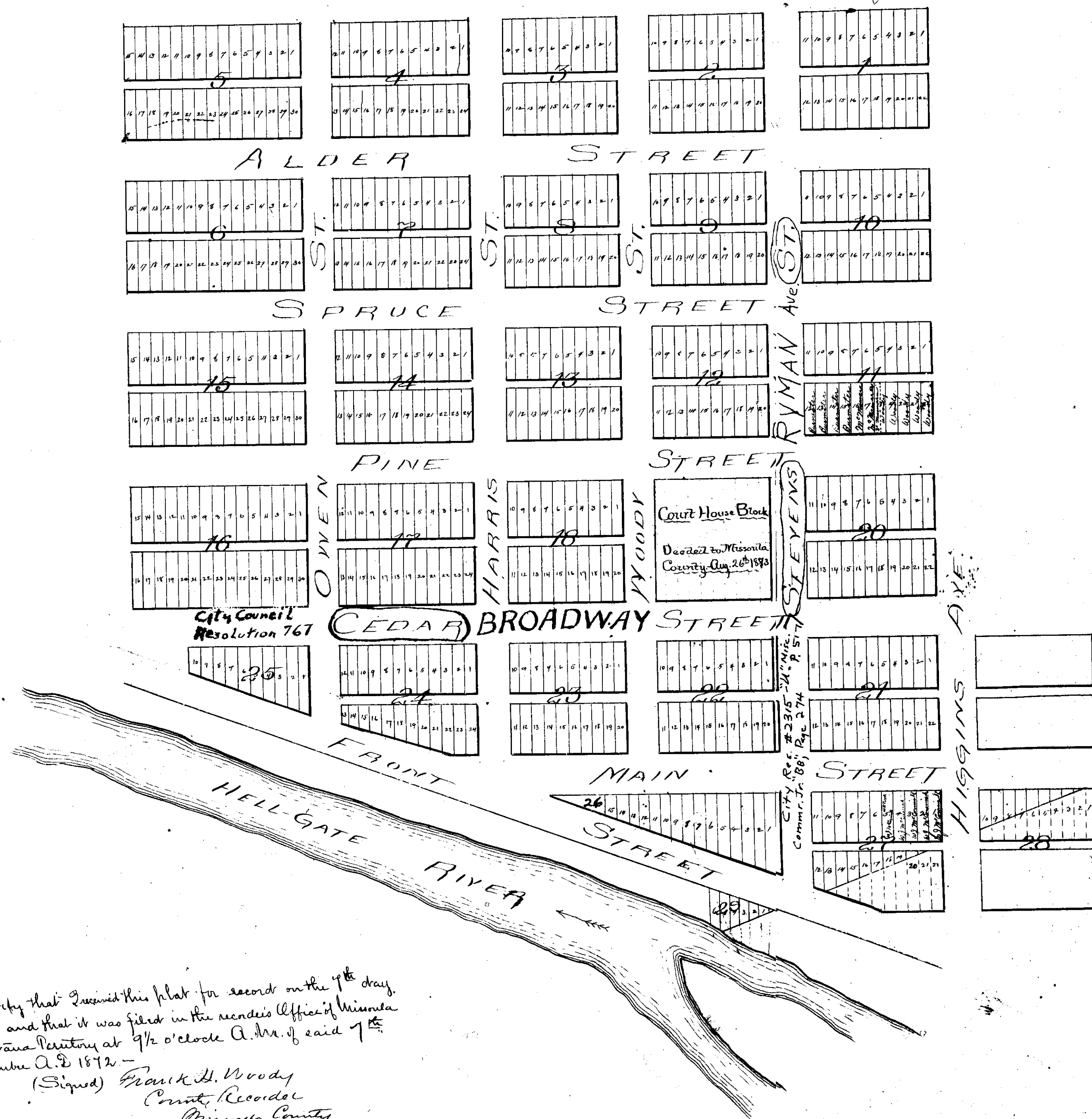

I hereby certify that I received this plat for record on the 9th day of November, and that it was filed in the records office of Missoula County Montana Territory at 9 1/2 o'clock A.M. of said 9th day of November A.D. 1872.
 (Signed) Frank H. Woody
 County Recorder
 Missoula County
 Montana Territory

Territory of Montana }
 County of Missoula }
 I, D. D. Bryant, County Clerk of the County aforesaid do hereby certify that the above is a true and correct copy of the original plat of Higgins & McCormick's addition to Missoula.
 In Witness whereof I herewith set my hand and the seal of Missoula County this 6th day of September A.D. 1889.
 R. D. Bryant
 County Clerk

STATE OF MONTANA }
 County of Missoula }
 I, _____, County Clerk, do hereby certify that the above plat was deposited and filed in a full, true and correct copy of the original. Witness my hand and the seal of said County this _____ day of _____, 18__.
 ATTEST:

 County Clerk, Missoula County, Montana