

FREISHEIMER'S ADDITION.

IN 5 ACRE TRACTS.

100 FT. TO 1 IN.

STATE OF MONTANA }
COUNTY OF MISSOULA }

I, George Freisheimer, do hereby certify that I have caused to be surveyed, subdivided, into lots and streets, the following described tract of land, shown by the plan and certificate of survey hereunto annexed, to wit: The Southwest one-quarter of the Southwest one-quarter of Section Twenty, (20) Township Thirteen (13) North, Range Nineteen (19) West of the Montana Principal Meridian, to be known and designated as "FREISHEIMER'S ADDITION", and the streets shown on the annexed, to be and hereby are granted and donated to the use of the public forever.

Geo. Freisheimer

Subscribed and sworn to before me this 10th day of June A.D. 1902.

Dan H. Ross

Notary Public in and for Missoula County, Montana.

SEAL

STATE OF MONTANA }
COUNTY OF MISSOULA }

O. C. Finkenburg, being first duly sworn, says he is the engineer under whose supervision the survey and plan hereon were made, in Missoula County, Montana, that the annexed plan is a correct representation and diagram, and that said addition is laid out according to the law, and that the width of the streets and the measurements of the lots, and the posts for reference points are correctly represented on said plan.

O. C. Finkenburg

Subscribed and sworn to before me this 10th day of June A.D. 1902.

Wallace P. Smith

Notary Public in and for Missoula County, Montana.

SEAL

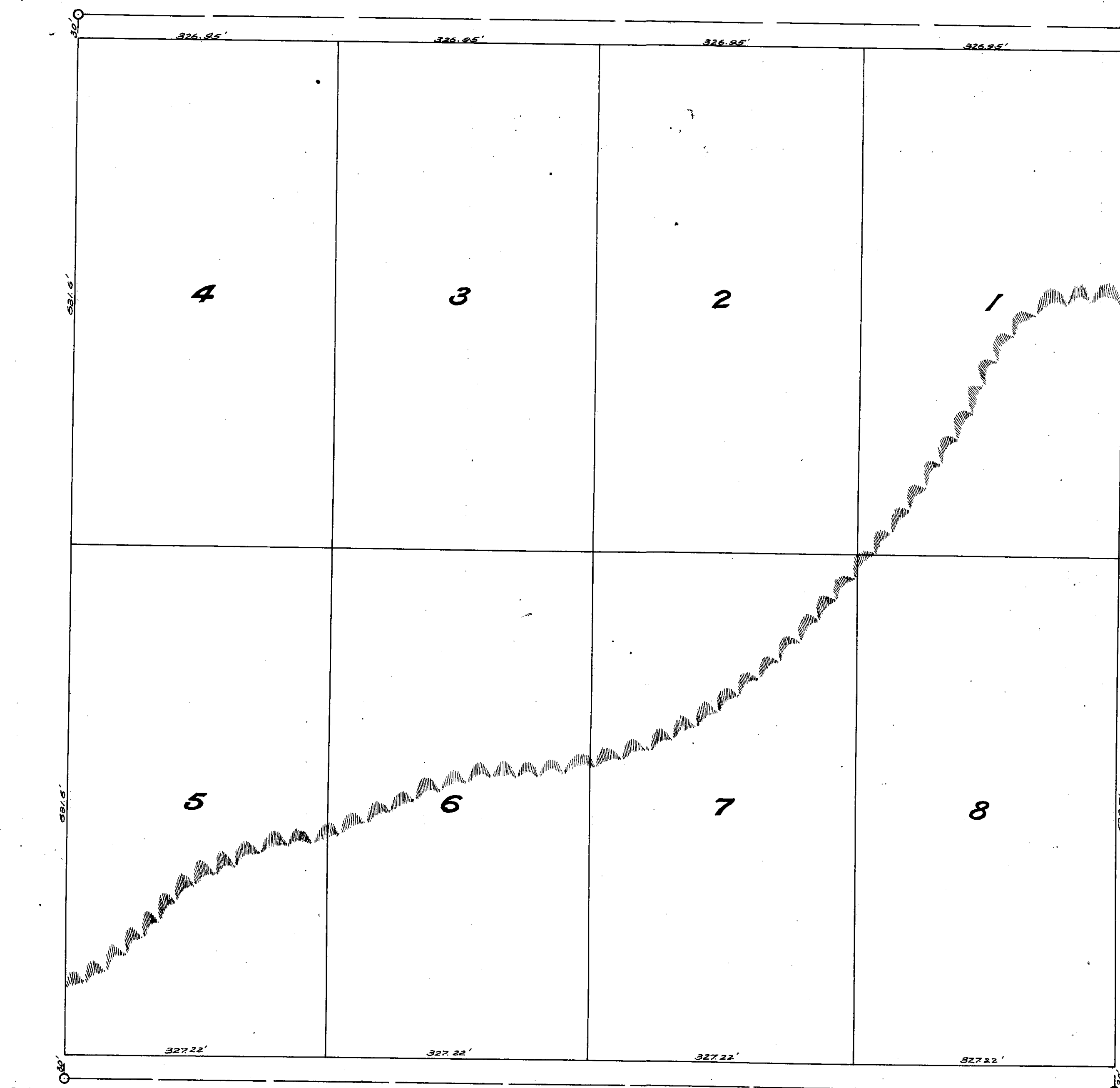

S.M. Con. Sec. 20, T. 13N. R. 19W.

STATE OF MONTANA }
COUNTY OF MISSOULA }

SURVEYOR'S CERTIFICATE

I, O. C. Finkenburg, do hereby certify that I am an engineer and that I have caused to be surveyed, subdivided, into lots and streets, the following described tract of land, shown by the plan and certificate of survey hereunto annexed, to wit: The Southwest one-quarter of the Southwest one-quarter of Section Twenty, (20) Township Thirteen (13) North, Range Nineteen (19) West of the Montana Principal Meridian, to be known and designated as "FREISHEIMER'S ADDITION", and the streets shown on the annexed, to be and hereby are granted and donated to the use of the public forever.

Compared this 26th day of January 1905

ATTEST:

O. C. Finkenburg
County Engineer, Missoula County, Montana.

Subscribed and sworn to before me this 10th day of June 1902

Notary Public in and for Missoula County, Montana.

STATE OF MONTANA }
COUNTY OF MISSOULA }

I hereby certify that the foregoing instrument was filed in my office on the 10th day of June A.D. 1902 at 4 o'clock P.M., and is recorded on page 6 of plats of Missoula County Records.

SEAL

H.T. Wilkison

Clerk and Recorder of Missoula County, Montana.

This plat is hereby approved this 21 day of July A.D. 1902.

SEAL

John Bonner
August Hollensteiner
Peter Scheffer

County Commissioners of Missoula County, Montana.