

See correction affidavit  
Book of Misc. "K", Page 620.

PLAT  
Showing Subdivisions of  
Original Block "C."

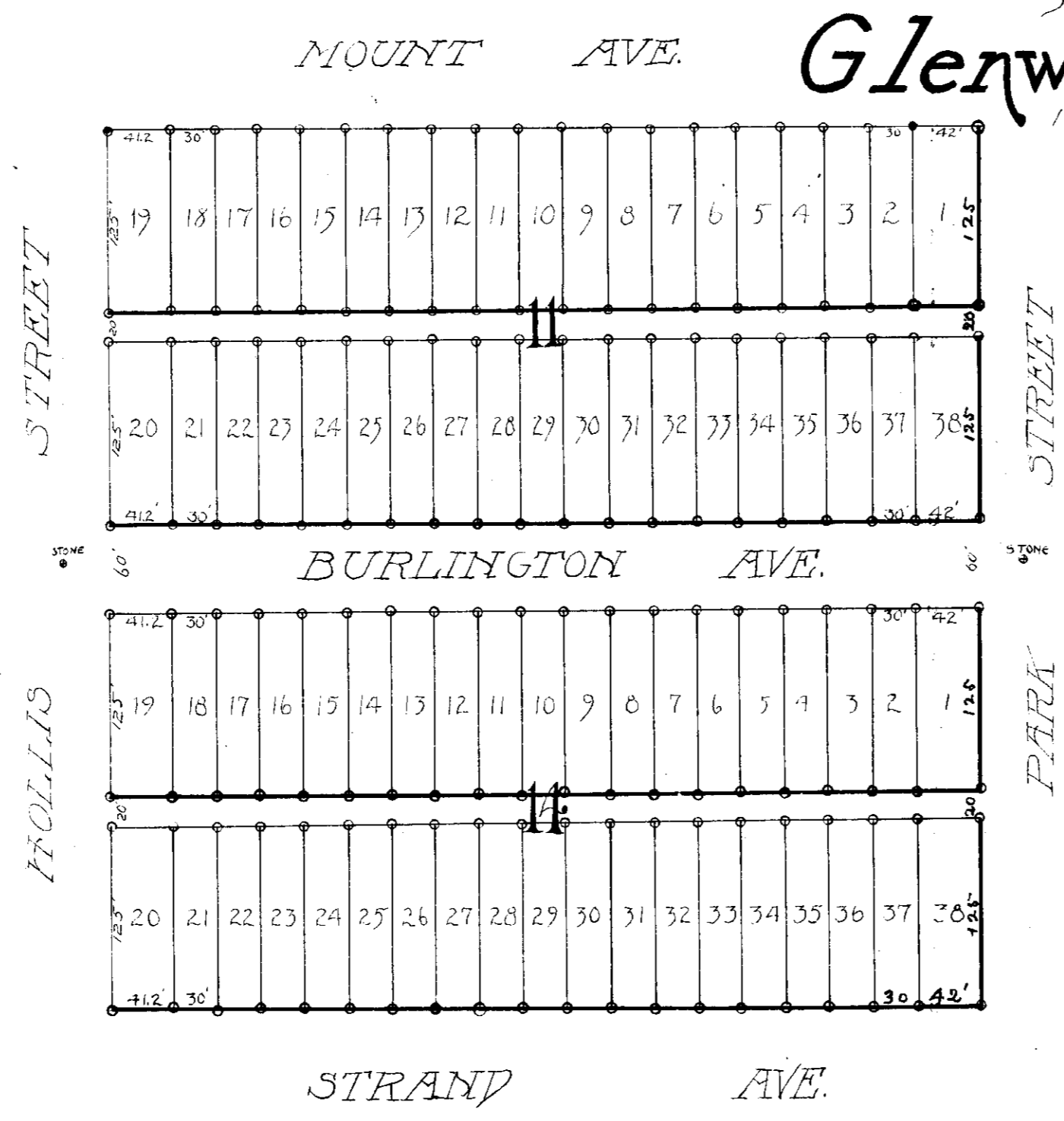

**Glenwood Park**  
11-100" E.S. Hathaway  
1909

State of Montana } ss.  
County of Missoula }  
We, A.L. Shapard and Max, his wife, being the owners in fee, of all the land embraced in Block "C" Glenwood Park Addition to the Town of Missoula, lying in the NE 1/4 SE 1/4 of Sec. 28, T.13, N.R. 19 1/2, Montana Meridian, have caused the same to be surveyed and platted into blocks, streets and alleys, with dimensions, numbers and names, as shown by the accompanying plat, and the streets and alleys, thereof are hereby dedicated to public use forever.

A.L. Shapard  
Max Shapard  
Wm. Dyson

Subscribed and sworn to before me, this 30<sup>th</sup> day of March 1909.  
Notary Public in and for Missoula County, Montana.

State of Montana } ss.  
County of Missoula }  
E.S. Hathaway being first duly sworn, deposes and says, that he is a Civil Engineer; That during the month of January 1909, he surveyed and platted Block "C" Glenwood Park Addition, according to the accompanying plat.

E.S. Hathaway  
Wm. Dyson  
Notary Public

Subscribed and sworn to before me, this 30<sup>th</sup> day of March 1909.  
Notary Public in and for Missoula County, Montana.

This plat is hereby approved this 5 day of April 1909

D. T. Curran, Chm  
Frank Nelson  
Tyler Worden

County Commissioners of Missoula County, Montana.

- Legend:
- Iron Pins
  - Stone below jurispace

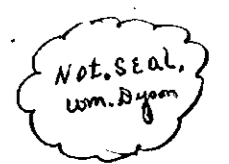

I Certify that I received and filed  
this instrument for record on the  
5<sup>th</sup> day of April  
1909... at 3:40 o'clock, P.M.  
R. W. Kuphal  
County Recorder.

STATE OF MONTANA, } ss.  
County of Missoula, }  
I, R. J. Hale, on my oath deposes and  
says: That I am an engineer under whose supervision the above plat  
was compared and find this a full, true and correct copy of the original.  
Compared this 20<sup>th</sup> day of January 1925.  
ATTEST: \_\_\_\_\_  
Subscribed and sworn to before me this 5 day of Feb 1925  
County Recorder in and for Missoula County, Montana